



*Our Unique Venue. Your Unique Event.*





# Welcome

Located in the heart of Mayfair, The Royal Institution is home to a stunning mix of Georgian and contemporary spaces suitable for up to 400 people.

Perfect for all events; from conferences and meetings to drinks receptions, parties and formal dinners. We have a dedicated in-house events team who will support you every step of the way and help to deliver your perfect event.

The Royal Institution is steeped in history. Over the last 200 years, the Ri has been home to many eminent scientists whose discoveries have shaped the modern world; from Michael Faraday's work on electromagnetic induction to Kathleen Lonsdale's pioneering use of X-rays to study crystals.

These scientists understood the importance of sharing their work with the public and as an independent science charity, our vision is a world where everyone is inspired to think more deeply about science and its place in our lives.

All proceeds from Ri Venue are donated to support the charitable activities of The Royal Institution.







Ri Venue has a dedicated in-house event and AV team on site to ensure the success of your event.

#### DEDICATED EVENT MANAGEMENT

Our dedicated events team will be on hand to provide expert support and guidance from enquiry through to event day.

#### EXPERT HOSPITALITY

Our passionate team will work with you to create the perfect menu for your guests.

#### SPECIALIST TECHNICAL SUPPORT

Our team of AV technicians are available to advise you on all technical requirements as well as supporting your event throughout the day.

#### COMPLIMENTARY WI-FI

Unlimited complimentary Wi-Fi is provided throughout the venue for the convenience of you and your guests.

#### FLEXIBLE ROOM LAYOUTS

Our versatile spaces can be arranged in a variety of ways to suit your needs.

As you view each space in the brochure the capacity information is shown on each room page with the following symbols.



Theatre



Reception



Cabaret



Dining



Boardroom



# Our Spaces

With high ceilings and beautifully proportioned windows, our spaces offer natural daylight and a wealth of historical features all set against the backdrop of one of Mayfair's most prestigious streets.

## FIRST FLOOR

Our First Floor spaces flow together beautifully to create a flexible event space ideal for conferences, receptions, launches and formal dinners.

The original marble Grand Entrance staircase leads to our iconic Lecture Theatre or to the Library, Georgian and Writing Rooms, which can be used as one large interconnected catering room or used as individual breakout spaces.

Also included is the Demonstration Room, ideal as a breakout space or green room for speakers.

## CONVERSATION ROOM & MEZZANINE

A large, stylish room with bold décor, the very name of the Conversation Room could be a talking point for your guests! Conveniently located on the ground floor this is the perfect space for a conference, accommodating up to 50 guests cabaret or 100 guests theatre style.

Combined with the Conversation Room is the Mezzanine, a quirky and contemporary space ideal for catering and refreshments.



## EXCLUSIVE HIRE

Exclusive hire of all of The Royal Institution includes our Georgian rooms and the iconic lecture theatre on the First Floor, the Conversation Room and Mezzanine on the Ground Floor as well as the glass roofed Atrium and the Faraday Museum on the Lower Ground Floor.

Exclusive hire allows you the space and flexibility to design the perfect experience for your guests. It suits events with a large number of attendees or luxury events such as dinners, award ceremonies or launches.

## ROOM CAPACITIES

	THEATRE	RECEPTION	CABARET	DINING	BOARDROOM
The Theatre	400	-	-	-	-
The Library	90	100	40	80	38
Georgian Room	50	100	-	50	18
Demonstration Room	80	100	40	50	30
Writing Room	20	20	12	26	12
Conversation Room	100	100	50	80	38
The Mezzanine	-	100	-	-	-
Sunley Room	30	-	30	-	-
Atrium and Exhibition	50	120	-	-	-









# The Library

At the top of the Grand Staircase is our stunning period Library, a historic room flooded with natural light and full of character.

It is available to hire individually or in conjunction with the adjoining Writing and Georgian Rooms; perfect for dinners, small presentations and receptions.

One of the special features of this room is the convex mirror above the fireplace commissioned by the Royal Institution which has remained in place since 1804. The room benefits from views of Albemarle Street, said to be the first one-way street in London due to the sheer volume of carriages arriving at The Royal Institution.

## WHAT'S INCLUDED

- Lectern
- PA system with one lectern and one handheld microphone
- Built in screen and floor standing projector

## CAPACITIES







# The Georgian Room

This light and airy room adjoins the Library and is an ideal hospitality space for events taking place on the First Floor. It can also be used for break-out sessions, exhibitions and networking.

The fireplace in the Georgian Room was originally situated in the home of Sir Joseph Banks and stood in the room where the founding meeting of The Royal Institution took place in 1799.



## CAPACITIES



75 m<sup>2</sup>



50



100



50



18

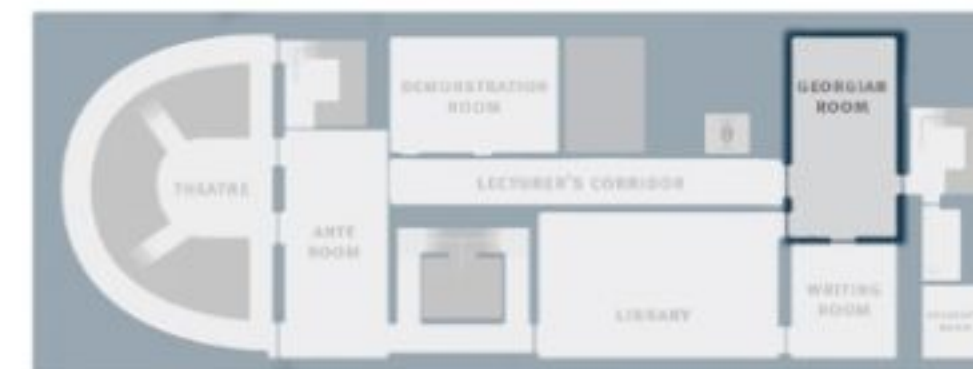





# The Demonstration Room

With fully integrated AV and adjustable lighting, this bright and contemporary event space is perfect for break-out sessions, presentations and receptions. A blank canvas with an industrial theme, this room provides a twist on tradition and a refreshing contrast to the other first floor rooms.

Formerly known as the Prep Room, this room was used to create scientific demonstrations enjoyed by those attending the Christmas Lectures.

## WHAT'S INCLUDED

- PA system with two handheld microphones
- Built in screen and projector
- Air conditioning

## CAPACITIES







# The Writing Room

This charming, book-lined room benefits from large floor to ceiling windows overlooking Albemarle Street, bathing the space in natural light.

This space is ideal for intimate meetings, interviews or briefings. Adjacent to both the Library and Georgian Room, it is also a useful overflow space for large first floor events, dinners or receptions.



## CAPACITIES







# The Conversation Room

This contemporary space with striking features is conveniently located on the Ground Floor next to the Grand Entrance. Versatile and spacious, it is suitable for small conferences, breakfasts and drinks receptions.

This space is hired with the adjoining Mezzanine to provide a dedicated catering and networking space.

## WHAT'S INCLUDED

- PA system with one lectern and one handheld microphone
- Built in screen and projector
- Air conditioning

## CAPACITIES

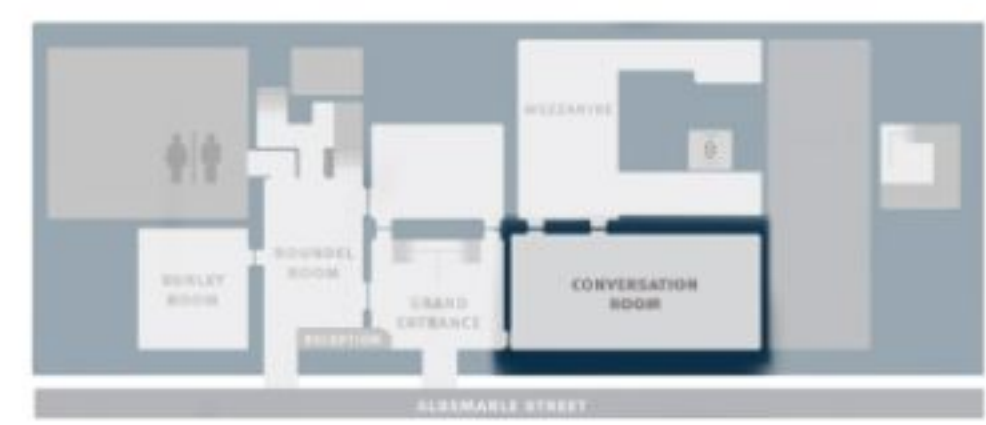
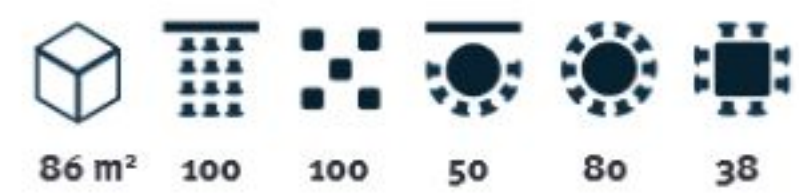





# The Mezzanine

Quirky and unique, the Mezzanine is an open plan area. Used in conjunction with the Conversation Room it makes an elegant hospitality and networking space for conferences or meetings. Its distinctive features and modern appearance make it the perfect backdrop for parties and receptions.

The focal point of the room is a large spiral ceiling installation showcasing 69 individual instruments from the Spottiswoode collection of miscellaneous optical apparatus.

## CAPACITIES



29 m<sup>2</sup>



100







# The Sunley Room

Conveniently located by the main reception, this light and airy room is perfect for smaller meetings and workshops as well as intimate dinners and board meetings.

## WHAT'S INCLUDED

- 50" plasma screen



## CAPACITIES



56 m<sup>2</sup>



30



30







# Atrium & Exhibition

The Atrium is a modern event space located in the centre of our building. A blank canvas, this space offers superb branding opportunities and is the ideal location to wow your guests with an explosive science demonstration or get your guests talking as a networking space or refreshment area.

Hire of the Atrium offers exclusive access to The Royal Institution's exhibition. From the odds and ends that became the first electrical transformer to the tube that told us why the sky is blue, see the real objects scientists built and used in some of the world's most famous experiments.

## CAPACITIES



84 m<sup>2</sup>



50



120





There is a member of our team waiting to discuss your next event.



Call us on **+44 (0)20 7491 6565**  
or email **[venuehire@ri.ac.uk](mailto:venuehire@ri.ac.uk)**

**[venue.rigb.org](http://venue.rigb.org)**

#### VIRTUAL TOUR

You can take a look around our extraordinary building from the comfort of your office with our virtual tour.

**[venue.rigb.org/virtual-tour](http://venue.rigb.org/virtual-tour)**

**Ri Venue**  
The Royal Institution of Great Britain  
21 Albemarle Street  
London W1S 4BS

NEAREST UNDERGROUND STATION  
Green Park

NEAREST OVERGROUND STATIONS  
Victoria and Charing Cross

Photography by

Paul Wilkinson, Katherine Leedale, Matt Chung, Paul Clarke,  
Tim Mitchell, Sarah Dick, Diana Novikova, Bozinovski Zvezdan,  
Insight Media, The Royal Institution

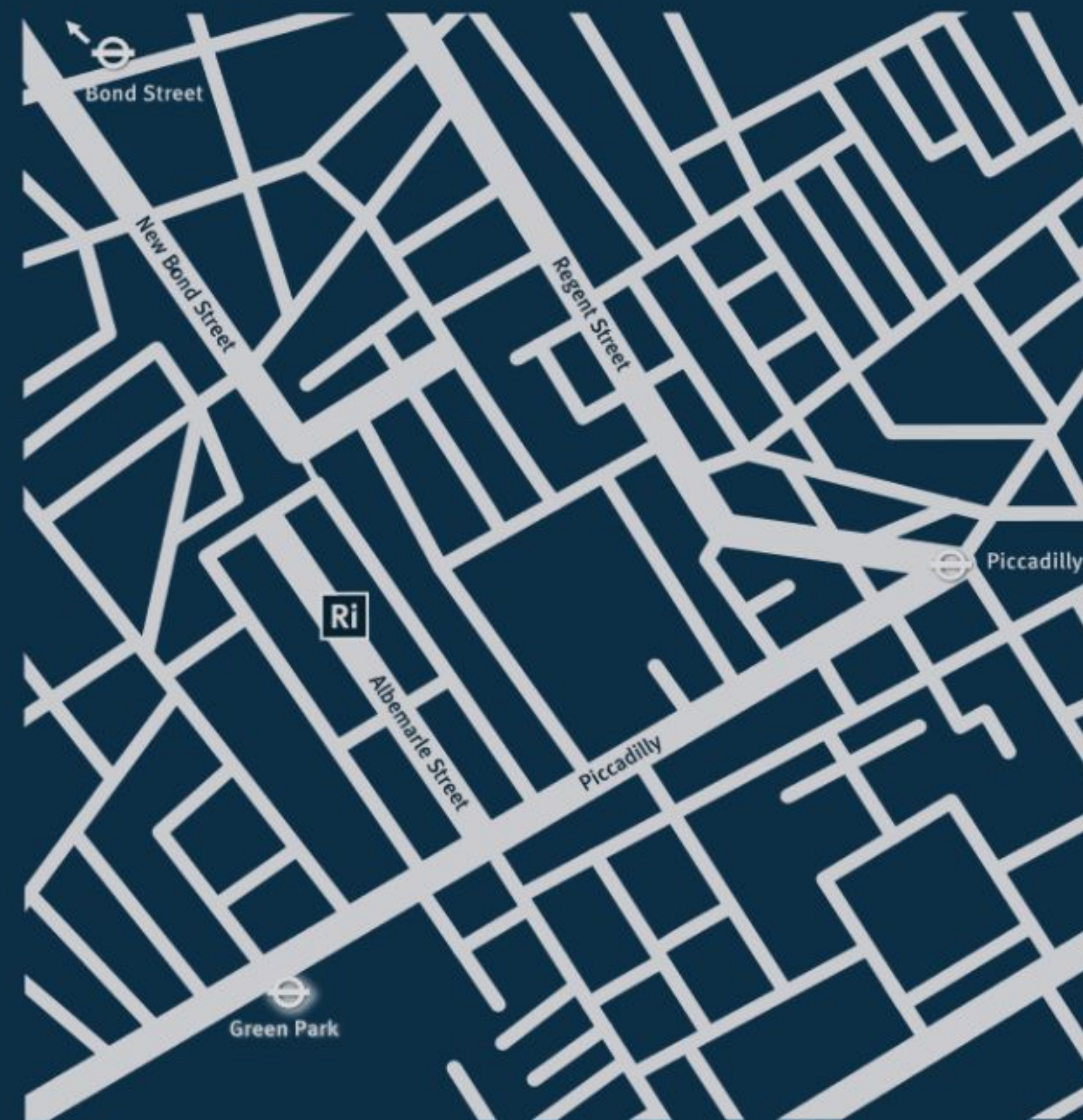





*Our Unique Venue. Your Unique Event.*

